

**ACOPLAMIENTO MODELO 180. DIAMETRO DE PASO 11 mm**
**AUTO-OBTURACION SIMPLE, CON BOTON DE DESCONEXION, ROSCADO.**

| REFERENCIA | ROSCA GW                                  |
|------------|---|
| 180/2 N    | Hembra a=3/8"<br>L = 68,5 mm<br>l = 10 mm |
| 181/2 N    | Hembra a=1/2"<br>L = 74,5 mm<br>l = 16 mm |
| 182/2 N    | Hembra a=3/4"<br>L = 74,5 mm<br>l = 16 mm |

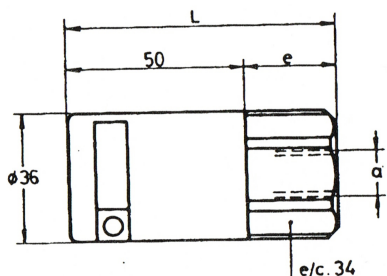
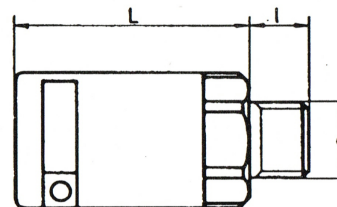
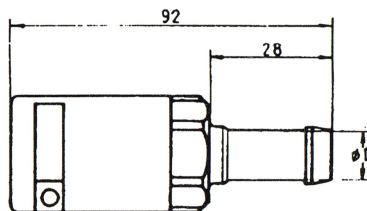

| REFERENCIA | ROSCA GW                                |
|------------|---|
| 183/2 N    | Hembra a=1/2"<br>L = 78 mm<br>l = 12 mm |
| 184/2 N    | Hembra a=3/4"<br>L = 78 mm<br>l = 16 mm |

**AUTO-OBTURACION SIMPLE, CON BOTON DE DESCONEXION, CON CABO PARA TUBERIA PLEXIBLE.**

| REFERENCIA | Diam. Interior Manguera |
|------------|-------------------------|
| 185/2/13 N | 13 mm.                  |
| 185/2/16 N | 16 mm.                  |
| 185/2/19 N | 19 mm.                  |

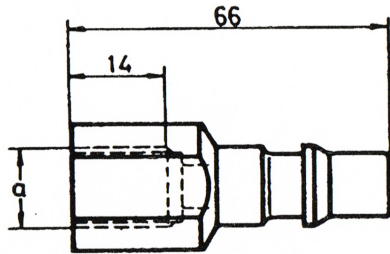
**ACOPLAMIENTO MODELO 180. DIAMETRO DE PASO 11 mm**
**ENCHUFE ROSCADO.**

| REFERENCIA | ROSCA GW      |
|------------|---------------|
| 180/30 N   | Hembra a=3/8" |
| 180/32 N   | Hembra a=1/2" |
| 180/31 N   | Macho a=3/8"  |
| 180/33 N   | Macho a=1/2"  |

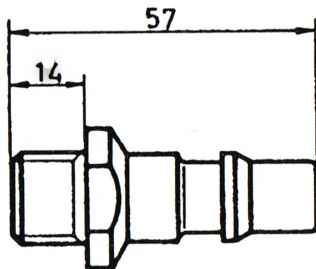
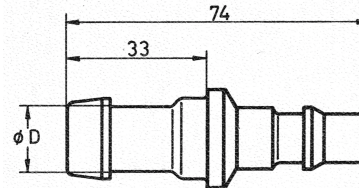
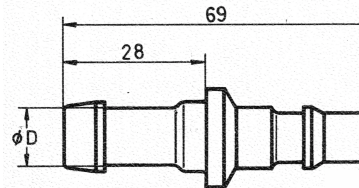
**ENCHUFE CON CABO PARA TUBERIA FLEXIBLE.**

| REFERENCIA  | Diam. Interior Manguera |
|-------------|-------------------------|
| 180/39/13 N | 13 mm.                  |
| 180/39/16 N | 16 mm.                  |
| 180/39/19 N | 19 mm.                  |